

Model GS5D

PINCH VALVES

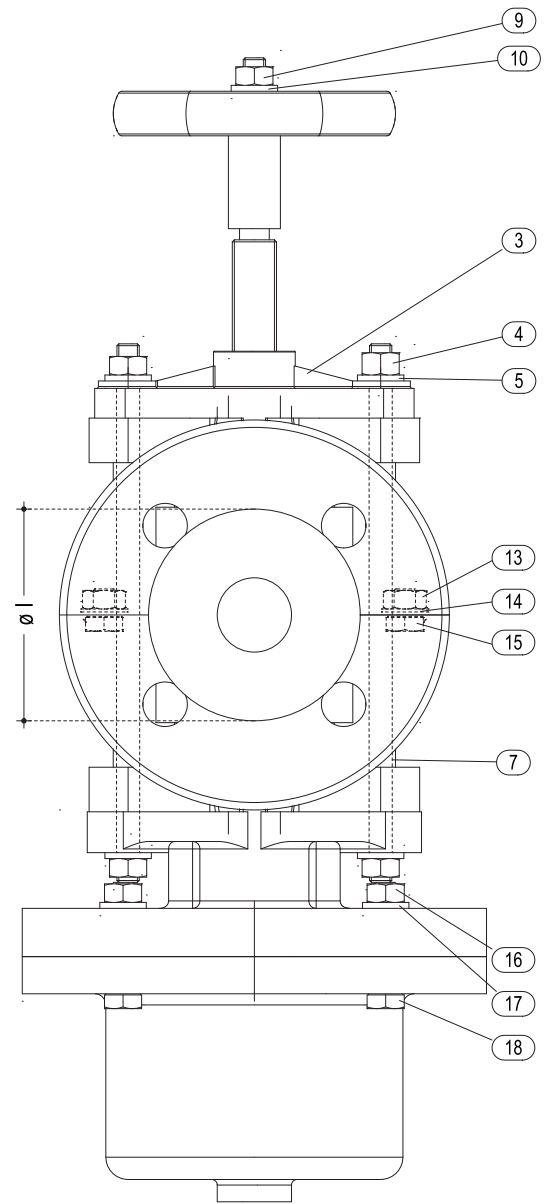
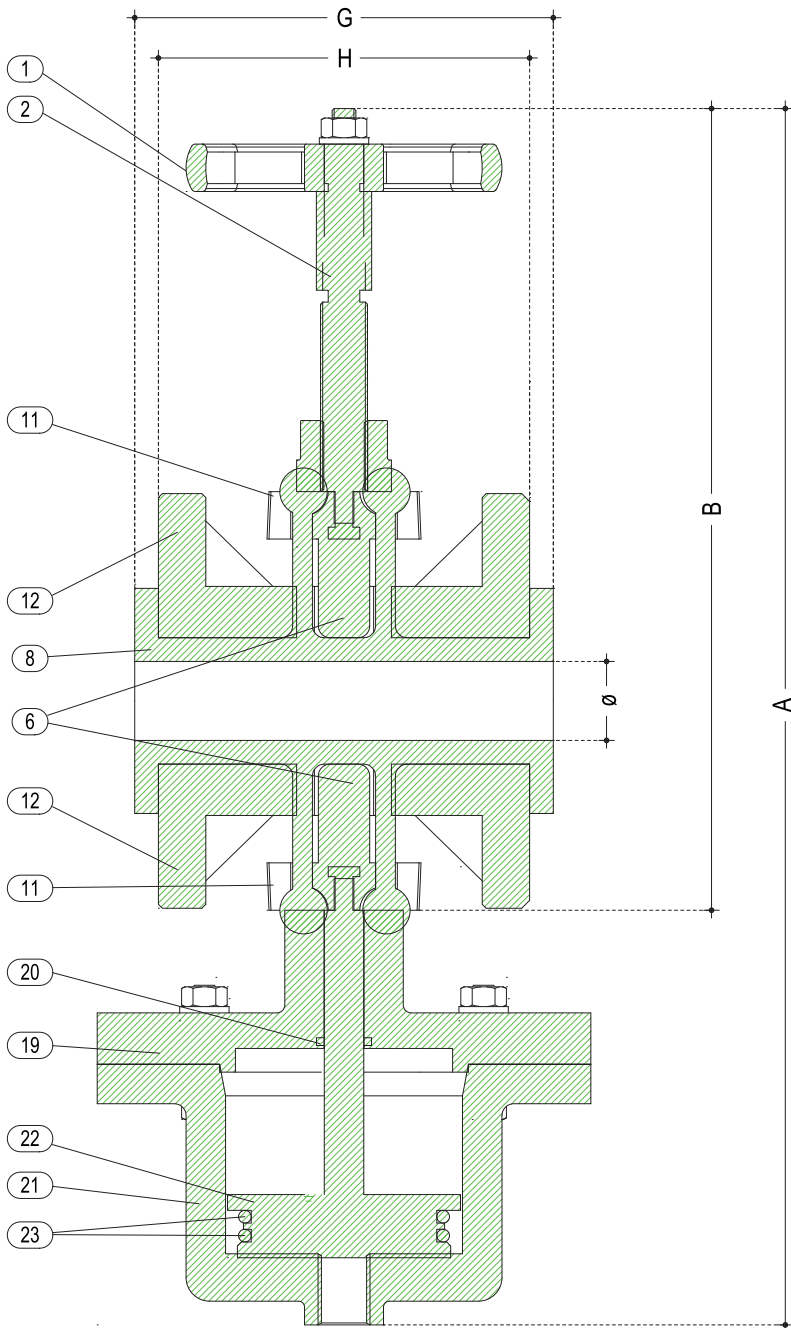

DETAILS

1	WHEEL
2	LEAD SCREW
3	SUPPORT
4	HEXAGON NUT
5	WASHER
6	PLUG
7	TIE ROD
8	RUBBER SLEEVE
9	HEXAGON NUT
10	WASHER
11	RETURN BUSHING BRONZE
12	VALVE BODY
13	HEXAGON NUT
14	WASHER
15	HEXAGON BOLT
16	HEXAGON NUT
17	WASHER
18	HEXAGON NUT
19	SUPPORT AND CYLINDER
21	CYLINDER
22	PISTON AND DRIVE PIN
23	"V" GASKET

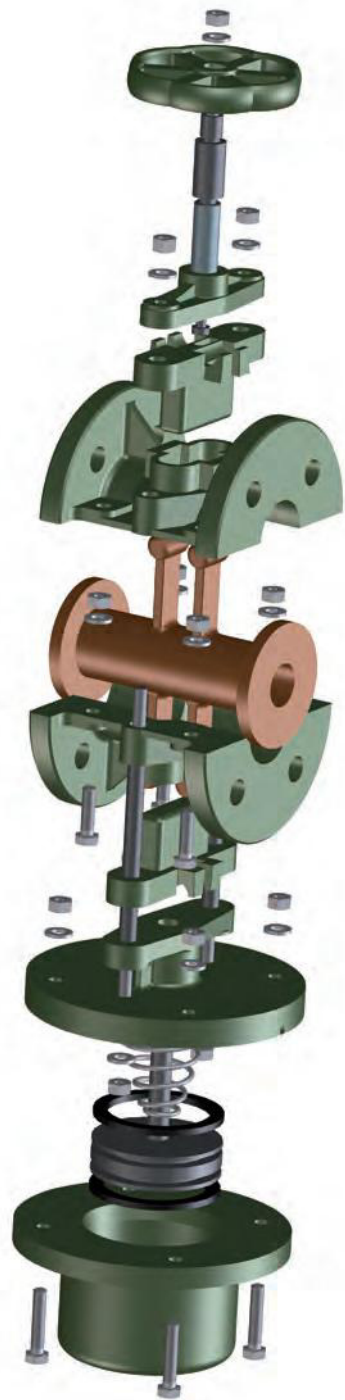
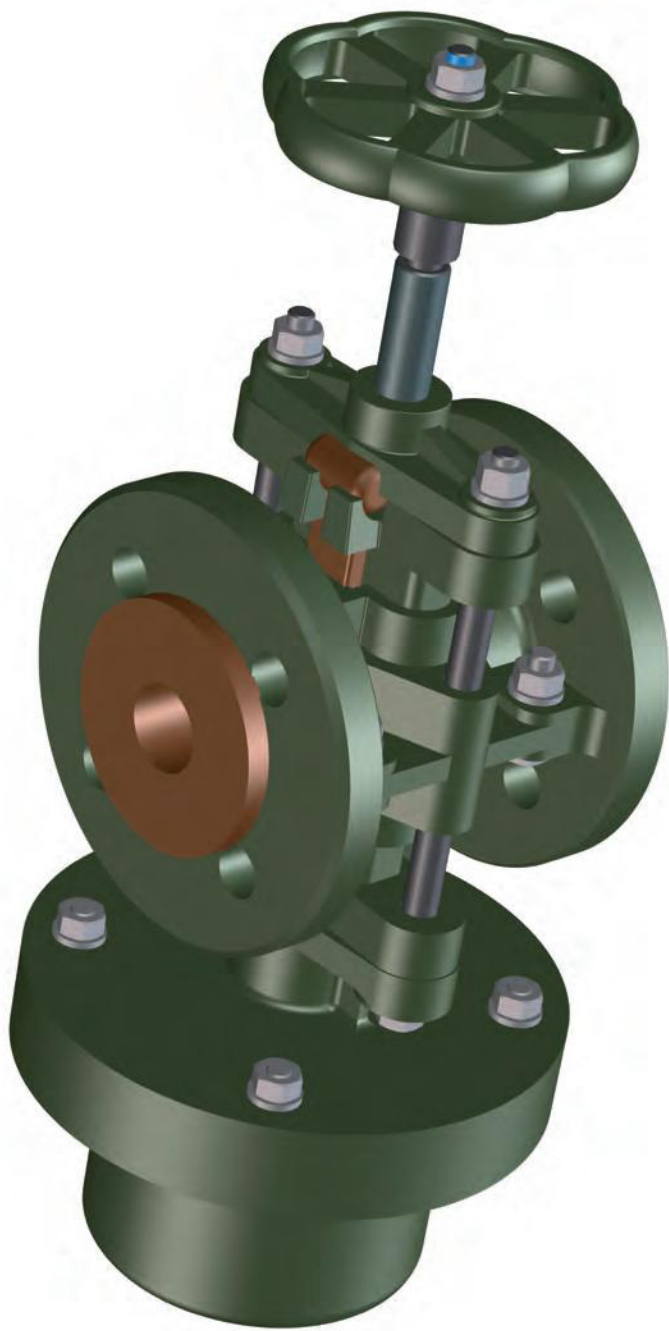

PRESSURE DETAILS UNI_1284

DN	P.N.	HYDRAULIC TEST kg/cm ²		WORKING PRESSURE kg/cm ²
		OPEN	CLOSE	
20	5	10	5	4
25	5	10	5	4
30	5	10	5	4
40	5	10	5	4
50	5	10	5	4
60	5	10	5	4
70	5	10	5	4
80	5	10	5	3
90	5	10	5	3
100	4	10	4	3
125	4	10	4	3
150	4	8	4	3
175	4	8	4	3
200	4	8	4	3

AIR PRESSURE REQUIRED KG/CM²

dn	20	25	30	40	50	60	70	80	90	100	125	150	175	200
min.	4	4	4	4	4	4	4	3,5	3,5	3,5	3,5	3,5	3,5	3,5
max.	6	6	6	5	5	5	5	4,5	4,5	4,5	4,5	4,5	4,5	4,5

WEIGHT KG

ALUMINIUM	C.I.
3,000	5,000
4,500	6,000
5,200	8,000
7,700	12,200
9,000	13,600
12,100	19,000
13,500	21,000
15,000	23,000
23,000	29,000
23,000	36,000
33,000	52,000
43,500	65,000
54,000	79,000
61,000	94,500

DIMENSIONS

Ø	A	B	G	H	I
20	310	205	107	95	58
25	345	220	118	106	68
30	380	245	130	115	78
40	445	300	154	140	88
50	495	330	176	160	102
60	525	350	194	180	130
70	565	280	206	190	137
80	605	410	215	196	148
90	665	450	250	232	178
100	715	490	275	260	158
125	850	600	300	280	198
150	935	650	330	300	222
175	1055	740	355	335	280
200	1142	800	375	350	298

NOTE: For different pressure details please ask the DPT

Model GS22

PINCH VALVES

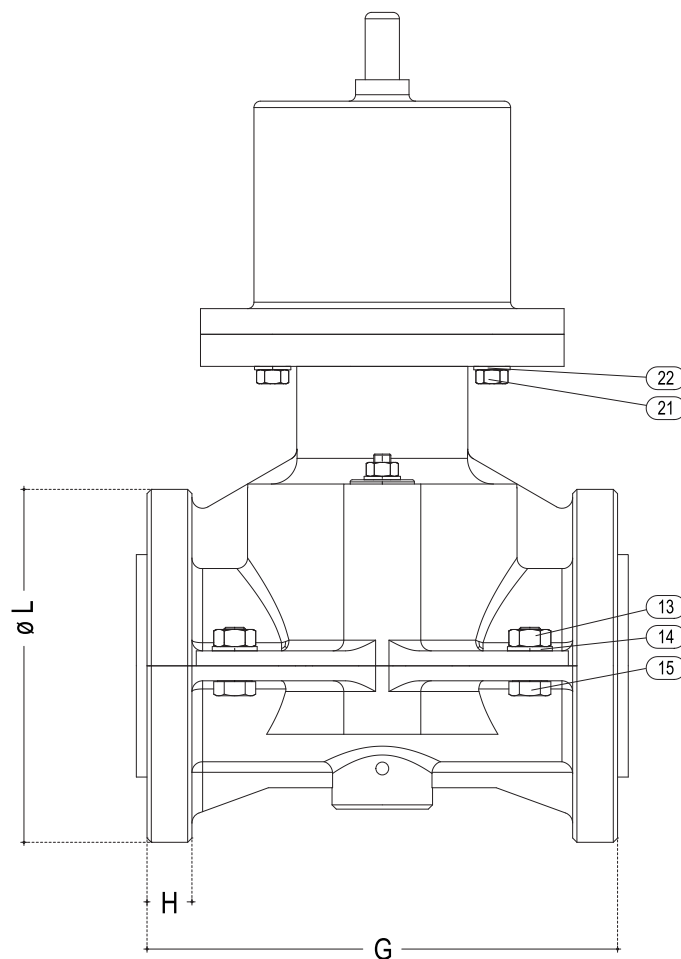
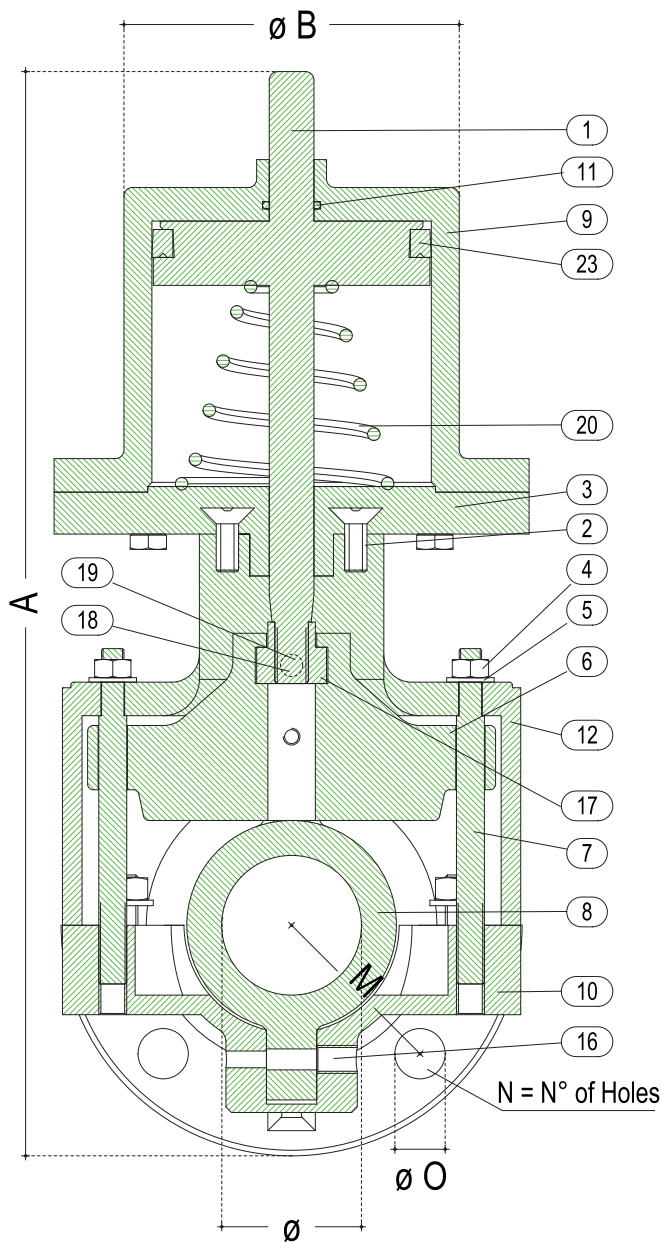

DETAILS

1	DRIVE PIN-PISTON
2	HEXAGON SOCKET HEAD
3	SUPPORT
4	HEXAGON NUT
5	WASHER
6	PLUG
7	TIE ROD
8	SLEEVE
9	CYLINDER
10	VALVE LOWER BODY
11	GASKET
12	VALVE UPPER BODY
13	HEXAGON NUT
14	WASHER
15	HEXAGON BOLT
16	SCREW SOCKET
17	BRONZE NUT
18	WASHER
19	CLAMPING SCREW FOR BUSHING
20	SPRING
21	HEXAGON BOLT
22	WASHER
23	"V" GASKET



PRESSURE DETAILS UNI_1284				
DN	P.N.	HYDRAULIC TEST kg/cm ²		WORKING PRESSURE kg/cm ²
		OPEN	CLOSE	
20	5	10	5	4
25	5	10	5	4
30	5	10	5	4
40	5	10	5	4
50	5	10	5	4
80	5	10	5	4
100	5	10	5	4
150	5	10	5	4

NOTE: For different pressure details please ask the DPT

AIR PRESSURE REQUIRED KG/CM ²								
dn	20	25	30	40	50	80	100	150
min.	4	4	4	4	4	4	4	4
max.	6	6	6	6	6	6	6	6

WEIGHT KG ALUMINIUM
2,300
3,200
4,200
6,000
8,000
14,000
31,000
49,000

DIMENSIONS						UNI PN 10				ASA 150			
Ø	A	B	G	H		L	M	N	O	L	M	N	O
20	240	80	140	14		105	75	4	14	98	70	4	16
25	278	100	150	14		115	85	4	14	108	80	4	16
30	317	100	170	16		140	100	4	18	118	90	4	16
40	366	118	190	18		150	110	4	18	127	98	4	16
50	395	118	220	21		165	125	4	18	152	120	4	19
80	482	145	300	22		200	160	4	18	190	152	4	19
100	698	162	340	22		220	180	8	18	229	190	8	19
150	866	220	470	20		285	240	8	22	280	241	8	22

Model GS27

PINCH VALVES

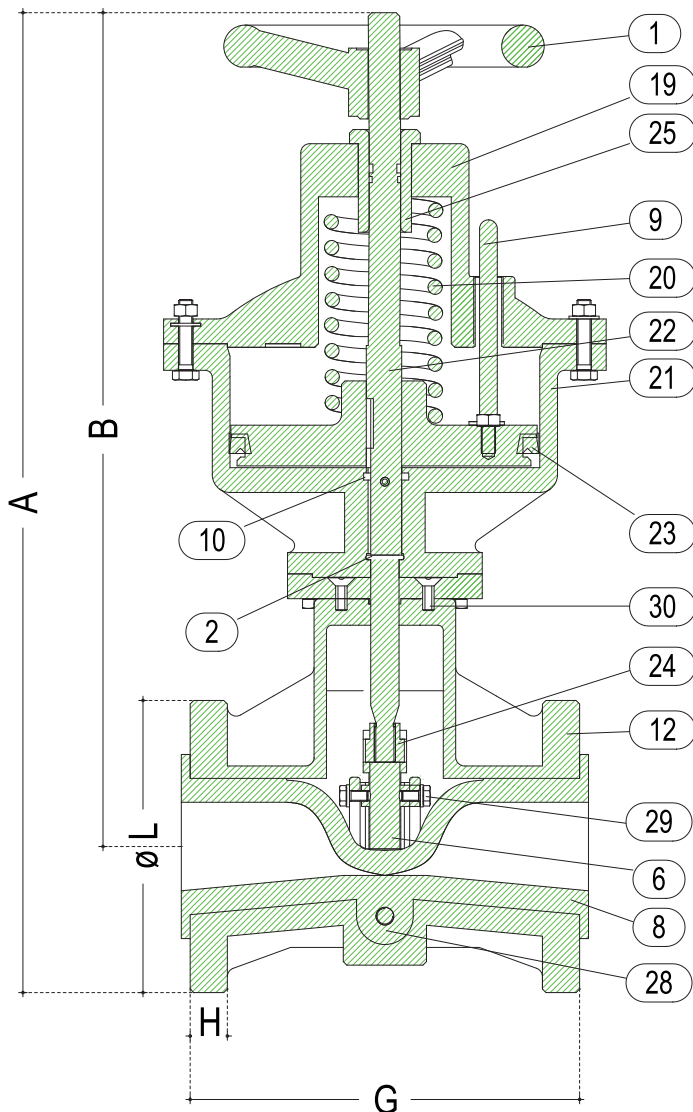
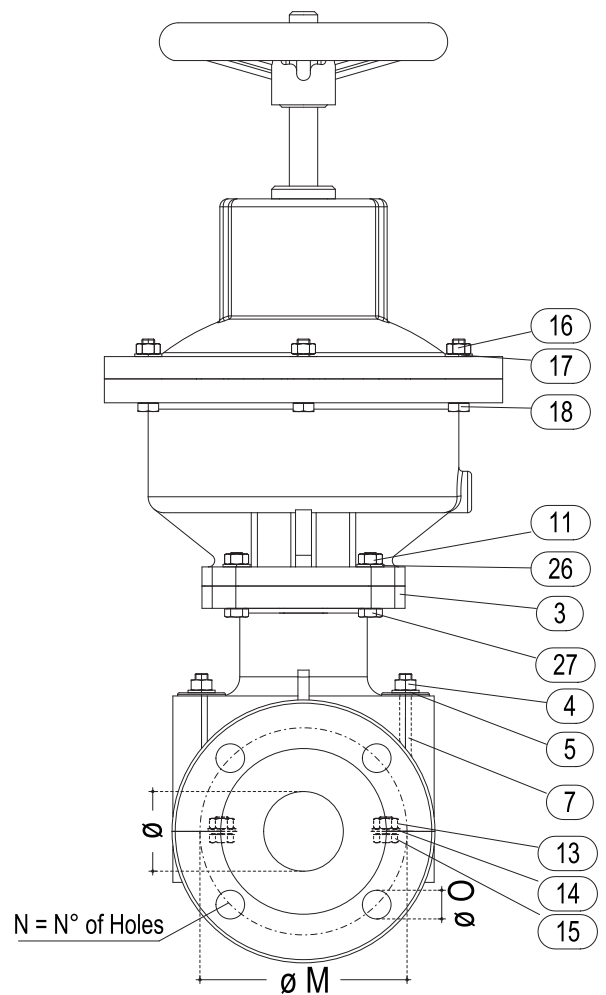

DETAILS

1	WHEEL
2	OR
3	SUPPORT
4	HEXAGON NUT
5	WASHER
6	PLUG
7	TIE ROD
8	SLEEVE
9	GUIDE PIN
10	GASKET
11	HEXAGON NUT
12	VALVE UPPER-LOWER BODY
13	HEXAGON NUT
14	WASHER
15	HEXAGON BOLT
16	HEXAGON NUT
17	WASHER
18	HEXAGON BOLT
19	COVER
20	SPRINGS
21	CYLINDER
22	PISTON
23	"V" GASKET
24	BRONZE NUT
25	BUSHING AND COVER
26	WASHER
27	HEXAGON BOLT
28	SCREW SOCKET
29	CLAMPING SCREW FOR BUSHING AND WASHER
30	HEXAGON SOCKET HEAD COUNTERSUNK HEAD SCREWS



AIR PRESSURE REQUIRED KG/CM ²								
dn	20	25	30	40	50	80	100	150
min.	4	4	4	4	4	4	4	4
max.	6	6	6	5	5	5	5	5

PRESSURE DETAILS UNI_1284				
DN	P.N.	HYDRAULIC TEST kg/cm ²		WORKING PRESSURE kg/cm ²
		OPEN	CLOSE	
20	4	10	4	3
25	4	10	4	3
30	4	10	4	3
40	4	10	4	3
50	4	10	4	3
80	4	10	4	3
100	4	10	4	3
150	4	10	4	3

NOTE: For different pressure details please ask the DPT

DIMENSIONS					UNI PN 10				ASA 150			
Ø	A	B	G	H	L	M	N	O	L	M	N	O
20	389,5	337	140	14	105	75	4	14	98	70	4	16
25	418,5	361	150	14	115	85	4	14	108	80	4	16
30	496	426	170	16	140	100	4	18	118	90	4	16
40	525	450	190	18	150	110	4	18	127	98	4	16
50	535,5	453	220	21	165	125	4	18	152	120	4	19
80	667	567	300	22	200	160	4	18	190	152	4	19
100	812	702	340	22	220	180	8	18	229	190	8	19
150	1130	987	470	24	285	240	8	22	280	241	8	22